

AIRFIELD NAME		September 24		COLL		EGEL		Scotland	
CALLSIGN (A/C RADIO)		Coll Radio					125.005		
CALLSIGN (ES/VATSIM)		EGEL_R_TWR					Elev. 21ft		
LOCATION		Lat N056.36.07.000			Long W006.37.04.000			QFE= QNH	
LOCATION GEOGRAPHIC		5 NM WSW of Arinagour. Isle of COLL							
CHART SOURCE		NATS		LOCAL HAZARDS: -Flocks of Greylag Geese around the A/F and Island all year round. Large numbers Airborne near sunrise/sunset.					
METAR AIRPORT		EGPL 113.950							
NAV AIDS	None; TIR VOR 117.7; MAC VOR 116.00				If a single A/C inbound, recommend 'Low pass, Go-Around', not below A800ft, to check for and clear runway of Birds, especially Geese and Gulls.				
RUNWAYS	Headings	Dimension	Surface						
	02 / 20	500M x 18M	Asphalt						
AIRSPACE	CLASS	Transition level 3000ft			Airspace above is Class C FL195, London FIR				
CIRCUITS	Left Hand, A1000ft, If single A/C recommend 'Low pass, Go-Around', not below A800, Bird clearance								
REMARKS	Monitor Tiree Information 122.700, inbound for runway 20, their centre-line passes within 1nm NW.								
HELICOPTERS	Helicopters as fixed wing, approach/depart not below A1000ft, due Bird traffic. Be aware of downwash when near other A/C.								

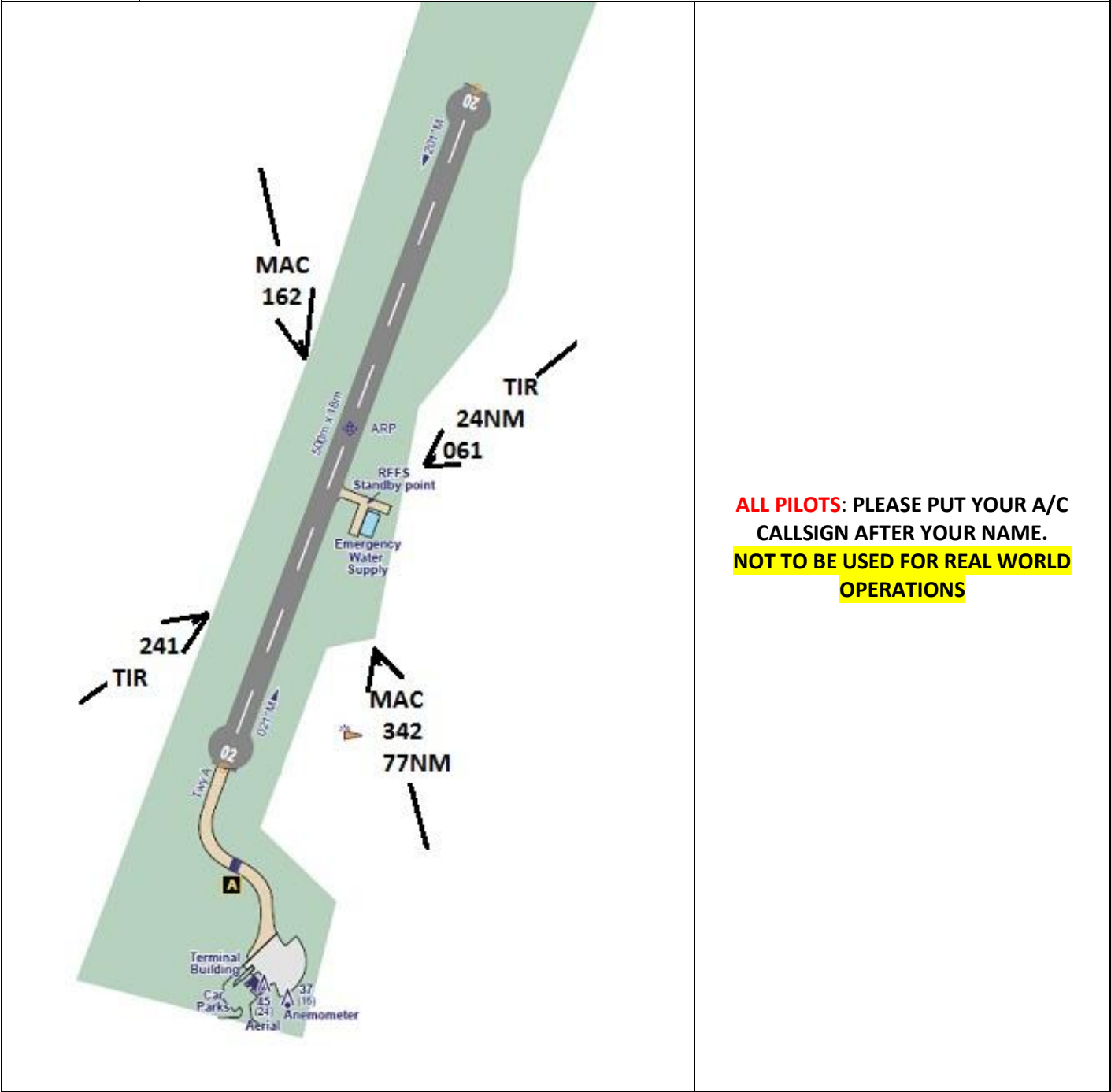

ALL PILOTS: PLEASE PUT YOUR A/C CALLSIGN AFTER YOUR NAME.

NOT TO BE USED FOR REAL WORLD OPERATIONS