

AIRFIELD NAME		January 25	HAVERFORDWEST		EGFE	West
CALLSIGN (A/C RADIO)		HAVERFORDWEST Radio			123.605	
CALLSIGN (ES/VATSIM)		EGEF_R_TWR			Ground. ----	
LOCATION		Lat N051.00.00.000	Long W004.57.39.000		Elev. 157ft	
LOCATION GEOGRAPHIC		2nm N of Haverfordwest / 10nm SSW of STU 113.10			VFR Conspicuity ---	
CHART SOURCE/VOR		NATS	VOR. STU.113.10,10nm E by N		App.----	
METAR AIRPORT		EGFF 132.480		NO NORDO A/C	QFE= QNH-5 HPscIs	
NAV AIDS [NOT RW]		NDB; HAV 328KHz on A/F.		Both, Range 10nm	DME HDW 116.75KHz.	
RUNWAYS	Headings	Dimension	Surface	NO FLY AREA / NOISE ABATMENT Avoid riding stables and houses North of 09/27 and maintain circuit position on downwind leg.		
	03 / 21	1524M x 45M	Asphalt			
	09 / 27	1095M x 45M	Asphalt			
AIRSPACE	CLASS G	Transition level 3000ft		Airspace above Class C FL195 London FIR		
CIRCUITS		1000ft QFE Flexwing Microlight A/C RH circuits. ALL OTHER A/C LH circuits				
LOCAL HAZARDS		Birds, especially SeaBirds. sometimes used by Mil A/C from RAF Valley for circuit training.				

SPECIAL RULES; PARACHUTING PROCEDURES

Parachuting takes place overhead the aerodrome. A/C are to request engine start when parachuting is taking place. On days parachuting is active, Runways 03 and 27 become RIGHT HAND CIRCUITS, and there will be, Subject to the notified runway in use, one of two parachute landing areas will be used. All aircraft are to stay live side of the airfield when parachuting is operational i.e. East of the runway when 03/21 in use, North of the runway when 27/09 in use. Aircraft must join (downwind / straight in) at or below 1000 FT on the QFE or AGL when parachuting is active.

HELICOPTER OPERATIONS

Not applicable: ALL
Helicopter operations are
unlicensed. - Fly as fixed
wing

A/G will notify when parachute descents are taking place, with "CANPOIES IN THE AIR"

1. Aircraft are to request engine start up when.
2. **No overhead or cross wind joins allowed when canopies are in the air..**

WARNINGS

Microflight flying and parachuting takes place on the aerodrome. The intersection of Runways 03/21 and 09/27 is liable to flooding during and after heavy rain. Hills rising to 259 FT AMSL within 2 NM to the east, rising to 276 FT AMSL within 1.5 NM to the northeast. and rising to 583 FT AMSL within 3.5 NM to the northwest.

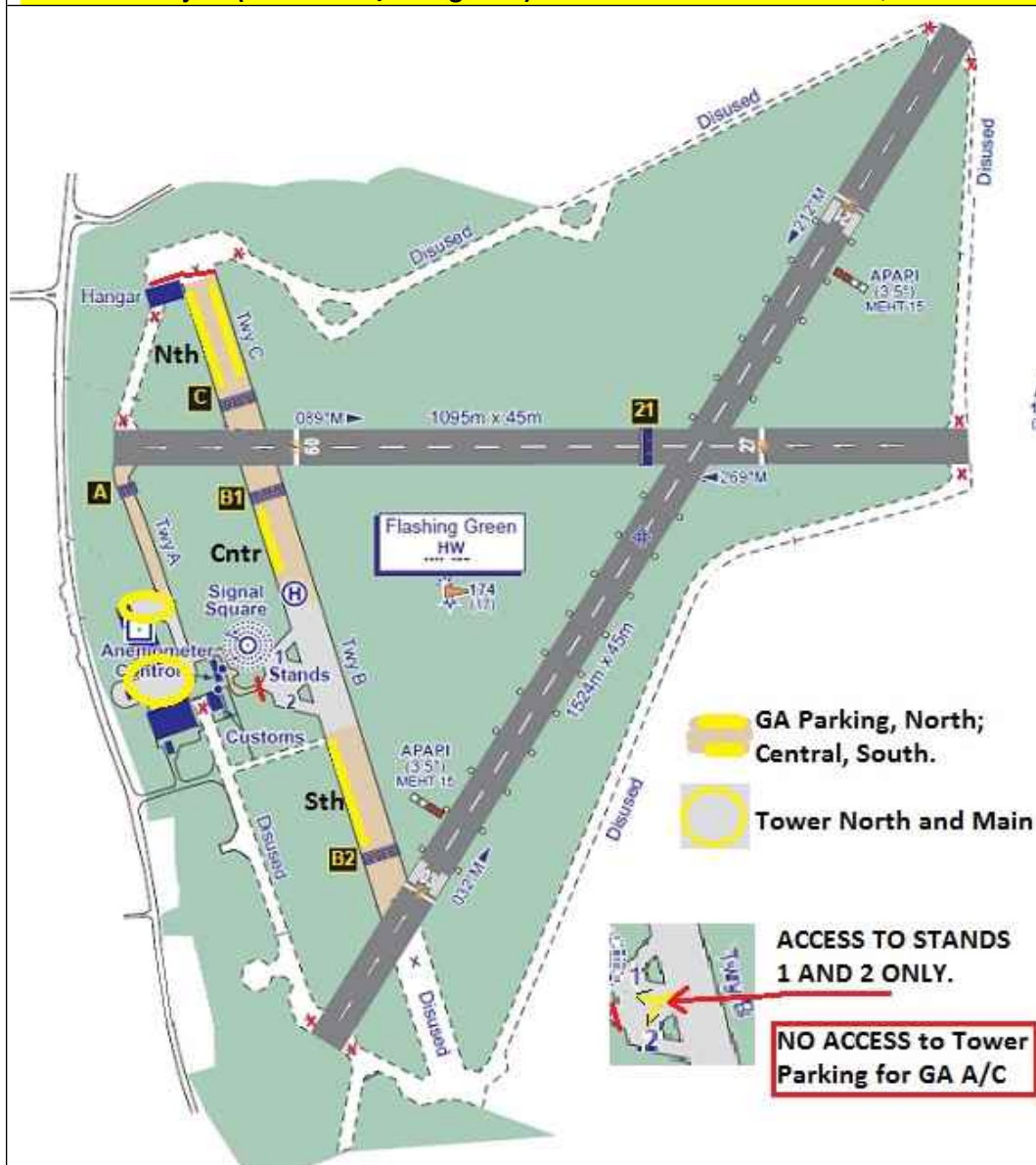

PILOTS: PLEASE PUT YOUR A/C CALLSIGN AFTER YOUR NAME. NOT TO BE USED FOR REAL WORLD OPERATIONS