

AIRFIELD NAME	January 25	LIVERPOOL				EGGP	North
CALLSIGN (A/C RADIO)		Liverpool Tower				126.355	
CALLSIGN (ES/VATSIM)		EGGP_TWR				Ground. 121.955	
LOCATION		Lat N053.20.01.000	Long W002.50.59.000			Elev. 81ft	
LOCATION GEOGRAPHIC		6.5nm SE of Liverpool				VFR Conspicuity ---	
CHART SOURCE	NATS	EGGP_DIR 118.455				RDR. 119.855	
METAR AIRPORT	EGGP 124.330	ILS 111.750				QFE= QNH- 2 HPscIs	
NAV AIDS (FSX / PLANG3)		NDB; LPL 349.50 4nm to 27 nmbrs			INBOUND/OUTBOUND VFR normally via VFR LANES & NESTON LANE LFA. SHIP CANAL via RUNCORN Bridge may be available. All A1500		
RUNWAYS	Headings	Dimension	Surface & notes				
	09 / 27	2285m x 46m	Asphalt				
AIRSPACE	CTR Sfc-2500 CLASS D		Trans 5000ft	Airspace above Class D Alt 2500-5500 CTA			
CIRCUITS	NOT BELOW 1500ftQFE		Variable circuits as instructed by ATC			NO OVERHEAD JOINS	
NO FLY AREAS	AS far as possible – STANLOW OIL REFINERY, 4nm South of the A/D. Strict lane flying essential. Avoid overflying Chemical works 1nm south of Runcorn bridge. DO NOT FLY South of LPL						
LOCAL HAZARDS	BIRD HAZARDS are common at any time, in particular, large flocks descending to the grass areas. A/C from the SOUTH, avoid chemical works on South bank of the Mersey, 1nm south of NDB						

HELICOPTER OPERATIONS Parts of manoeuvring area can be authorised by ATC for take offs and landings. Active runway threshold is a designated aiming point.

ARRIVALS will be instructed to the active threshold or to make a 'fixed wing approach', flaring to ground / hover taxi within the fixed wing touchdown zone. Arrivals / departures to / from the Alpha taxiway ONLY if approved by ATC. Limited training may take place on and around disused taxiway and Grass area WEST of Hold C, with ATC approval. Helicopters must remain clear of the runway c/l and boundary fence.

Wheeled helicopters **will use taxiways**; **light helicopters MUST hover taxi USING TAXIWAYS**

SPECIAL RULES **START UP** request or **STARTED** notification is required with **A/C location (stand/apron)**.

GRASS areas are unavailable to all A/C. **LANDING A/C Vacate as advised OR taxi to end of runway.**

UNLESS OTHERWISE INSTRUCTED by ATC, ALL VFR arrivals / departures via designated VFR lanes. DO NOT enter the CTR without clearance from ATC. VFR Entry / exit routes, not above 1500ft QNH.

You may be required to report passing relevant 'lane VRPs'.

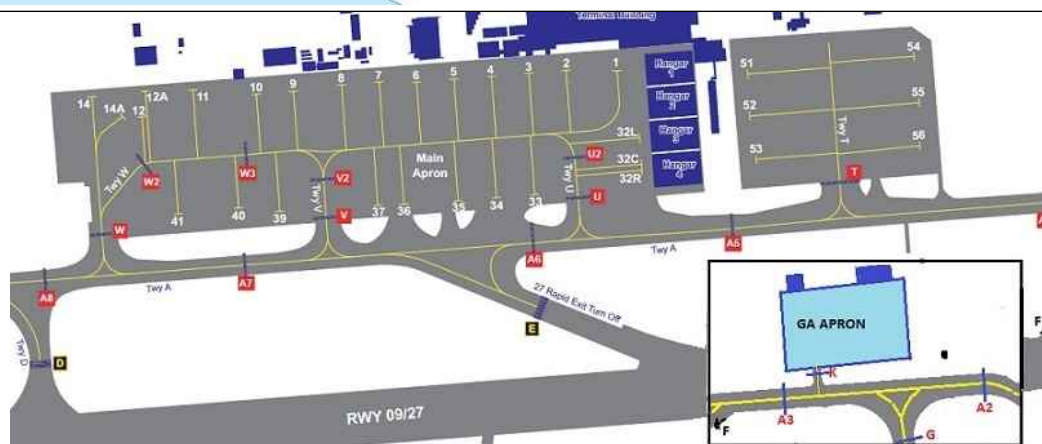

PILOTS:
PLEASE PUT
YOUR A/C
CALLSIGN
AFTER YOUR
NAME.

**NOT TO BE
USED FOR
REAL WORLD
OPERATIONS**

